

Model: FHS-FLASH

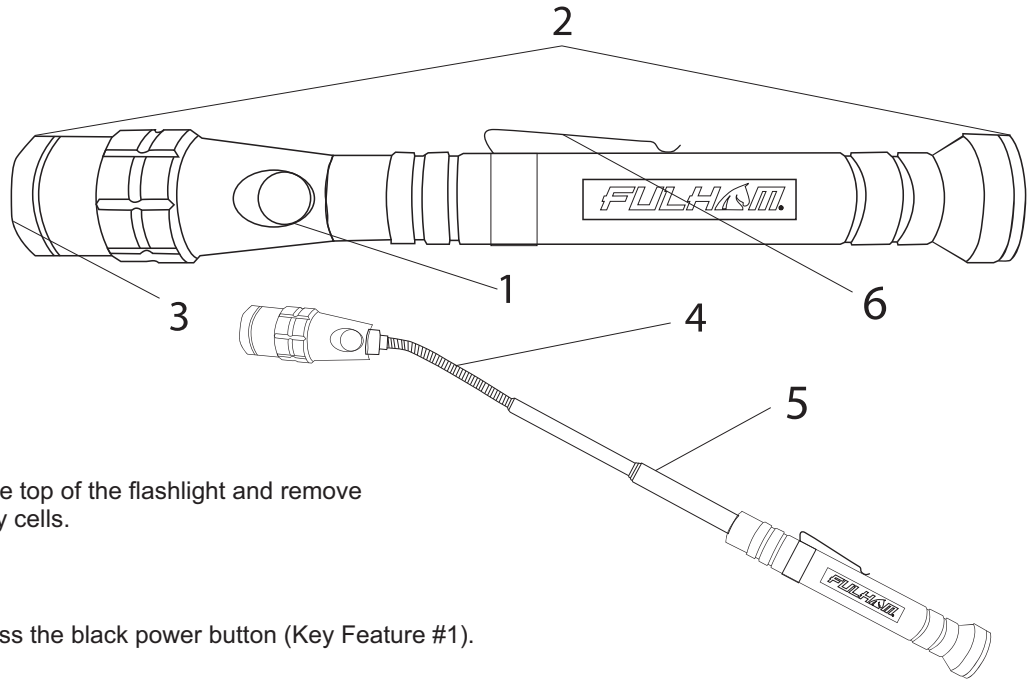

Key Features

1. Power Button
2. Magnetic Ends
3. Flashlight
4. Bendable Extension
5. Extensions Rod
6. Utility Clip

Getting Started

To enable operation, unscrew the top of the flashlight and remove the plastic cover from the battery cells.

Operating Instructions

Turning On The Flashlight:

To turn On/Off the flashlight, press the black power button (Key Feature #1).

Flashlight Head Extension Feature:

To use the extension feature, pull the head (LED side) of the flashlight to the desired length while holding the body. Once at the desired length, the extended rod can be bent to adjust the position of the light source as needed.

Using The Magnet:

Both ends of the flashlight have a built-in magnet that can be used to pick up metal objects or adhere to metallic surfaces.

Replacing The Batteries:

1. Unscrew the head of the flashlight and remove the black sleeve that contains all four batteries.
2. Replace with 4x LR44 coin cell batteries

Storing And Maintaining

Flashlight should not get wet or be exposed to extreme temperature conditions

- Do not disassemble the flashlight.
- If flashlight is submerged in water, let it dry completely before attempting to use
- Batteries should not be exposed to direct heat or sunlight for an extended period of time.

Battery Warnings

- Never mix alkaline, standard (carbon-zinc) and rechargeable (nickel hydride).
- Don't mix new and used batteries.
- Do not attempt to recharge non rechargeable batteries.
- Remove rechargeable batteries from the device before recharging them.
- Rechargeable batteries must always be charged with care.
- Remove used batteries.
- Always use the recommended or equivalent battery types.
- Always pay attention to battery polarity.

Warning:

You should not dispose of this device with your household waste. A selective collection system for this type of product is implemented by your local authorities. Please contact your local authorities to find out how to and where collection takes place. These restrictions apply because electrical and electronic devices contain dangerous substances that have harmful effects on the environment or on human health and must be recycled.

Specifications

- Model: FHS-FLASH
- Aluminum Flashlight W/ 3x LEDs
- Size: 6.77"(172mm) L x 0.87"(22mm) D, extendable up to: 22.2"(565mm)
- Weight: 0.21lbs(95g)
- Battery: 4x Coin Cell LR44 (Batteries included)
- Operational features: On/Off
- Runtime: 2 hours